



La Plata



History.

La Plata was one of the first houses built by Fannborg in the Ásgarður area in Kerlingarfjöll, to be used as a engine house for a diesel generator, later it was converted into a staff house for the Ski instructors and served as such until around 2000. In 2008 La Plata was refurbished, where the interior was renewed and since then it has two rooms, each with a double bed.

As La Plata is located on the hill above the Ásgarður Valley, it has one of the most picturesque view a chalet can have in the Icelandic Highlands, where the guests can see the to the Langjökull and Hofsjökull glaciers, the mountain ridge of Kerlingarfjöll and at a far distance, mountains around Skagafjörður and Húnavatnssýsla in the north.

The name “La Plata” does not sound Icelandic and it is not. The roof cover of La Plata is a corrugated steel plates and in the early days of this chalet, a strong wind took some of the plates and the humorous staff at that time gave the chalet its name after the steel plates, blowing away in the wind...





Facilities

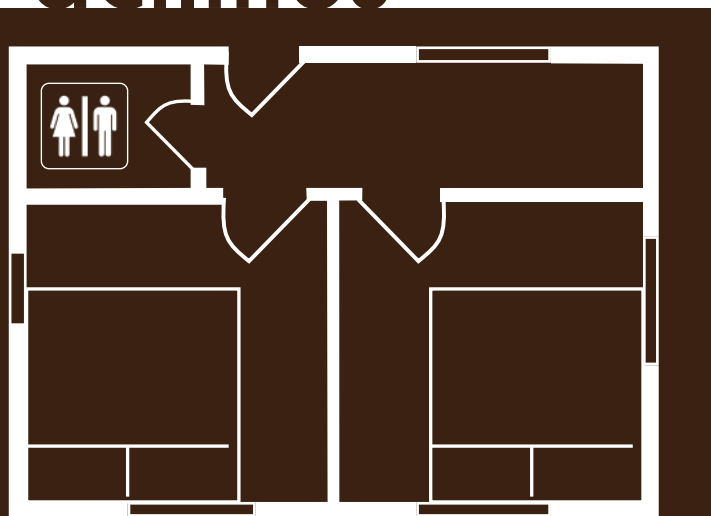

La Plata has two double beds, a bathroom and a kitchenette.

To reach La Plata, drive back to the entrance to the Kerlingarfjöll resort and take the road leading up toward the geothermal area. La Plata is alongside the road, overlooking the valley.

